

— INTRODUCING —

# BLUELAKE

AT NEWPORT COVE

Certainteed lifetime architectural roof shingles.

The Bluelake, a 1,465-square-foot ranch with two bedrooms, two baths, two-car garage and full basement, is the newest addition to Newport Cove's Cottages neighborhood.

The home will have the same high-quality finishes as our other Cottage homes.

We want to see this home come to life, so for a limited time, we will include a finished basement (full bath and rec room - approximately 900 square feet.) in the base price. And, yes, that's a once-in-a-blue-moon opportunity.

For further information, call us at 847.726.2727 or email us at [contact@newportcoveonline.com](mailto:contact@newportcoveonline.com).

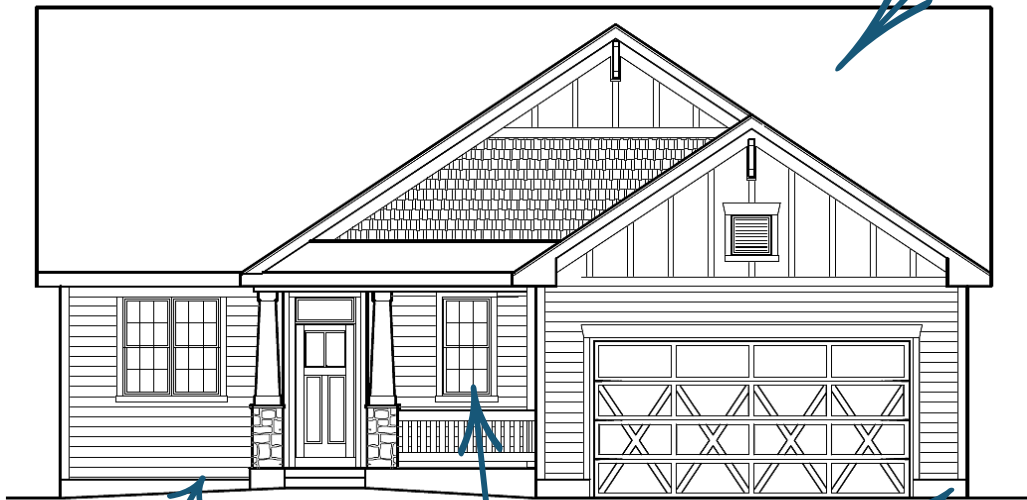

LP SmartSiding and SmartTrim with decades-long guarantees.

Andersen 100 Series windows.

State-of-the-art energy efficient building envelope, foundation, windows, insulation.

Flexible floor plan. Options for kitchen area/bonus space.

Patio becomes deck on lookout basement lots.

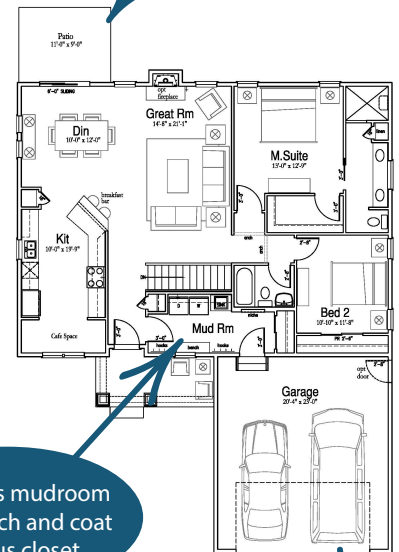
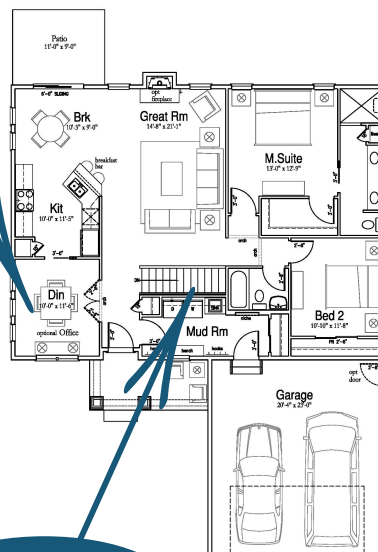
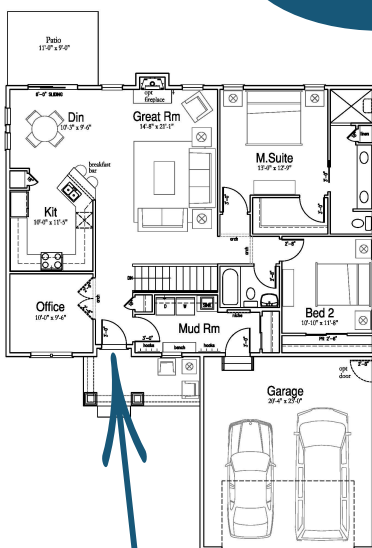

Custom 42-inch-wide entry door.

Stairs to full basement.

Generous mudroom with bench and coat hooks plus closet.

Garage fits two cars plus golf cart.